

**THE ROVER COMPANY LIMITED**  
**S E R V I C E   D E P A R T M E N T**

SOLIHULL, BIRMINGHAM, England  
Telephone Nos. : Sheldon 2461, 2613  
Telegrams : Rovrepair, Solihull

**Rover Service News Letter No. 40**

January 29th, 1954

TO ALL DISTRIBUTORS AND DEALERS

**GENERAL.**

**Item 1    ENGINE CONVERSION PARTS, LAND-ROVER**

The engine conversion parts listed in Service Bulletin 2/A4 will be chargeable as from this date. These parts are required when fitting 2.0 litre Land-Rover engines in place of 1.6 litre engines and will be charged at the normal price and discount.

**Item 2    JIG BLOCK FOR CYLINDER BORING LAND-ROVER AND CAR**

All Service stock of Jig blocks, part numbers 261287 and 261288, have been modified to make them suitable for the 1954 "60" and "75" and "90" respectively. Any stocks held by Distributors or Dealers can be modified as detailed in the sketch below, or alternatively they can be returned to our Service Department, where they will be modified free of charge.

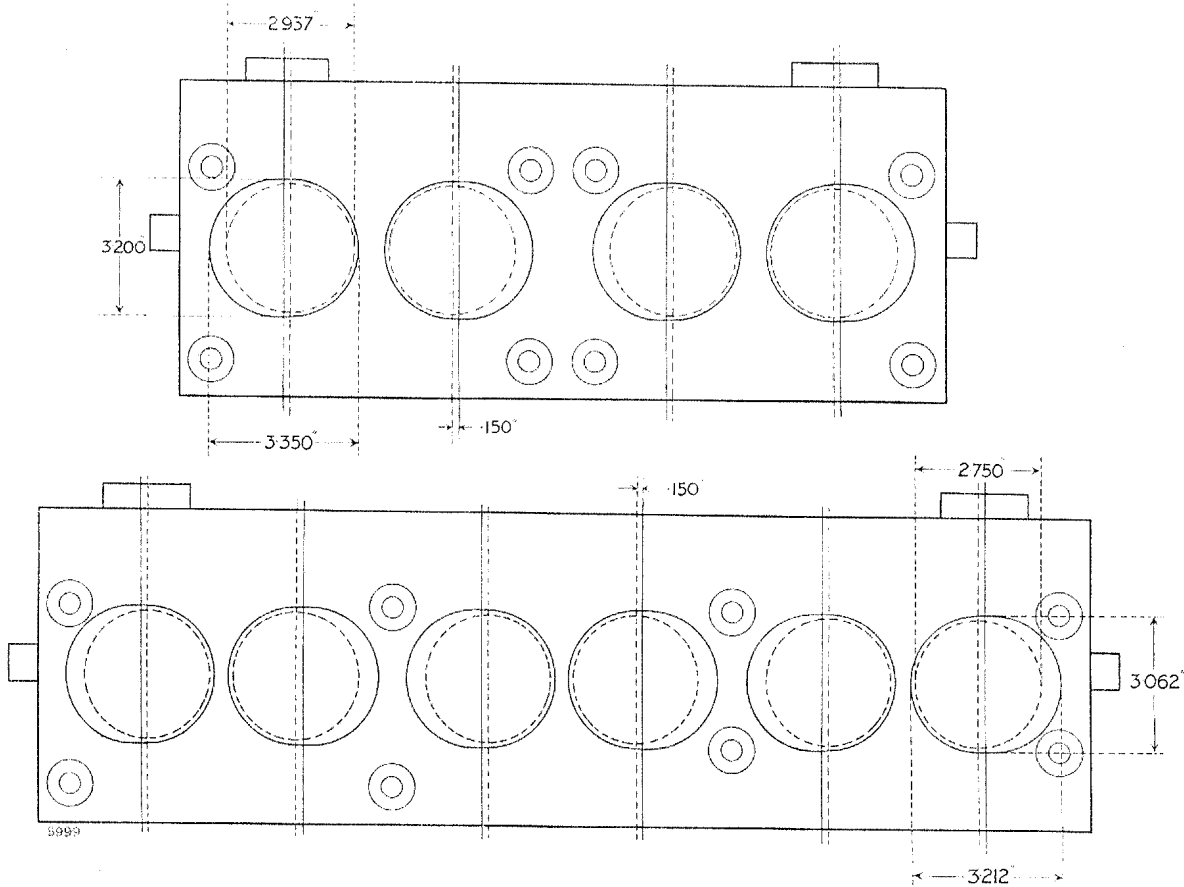

Modification of Jig Block : Bore out, using scrap cylinder blocks to dimensions shown, elongating each bore by .150 in. (3,81 mm). Dotted lines indicate original bore size and centres. Heavy lines show new bore size and centres.

ROVER SERVICE NEWS LETTER No. 40—*continued.*

- Item 3 WATER PUMP, LAND-ROVER AND CAR** Some confusion appears to exist in identifying the early and late type water pump, part numbers 233161 and 241884. The external appearance is similar, but 241884 can be easily identified as the outlet to the thermostat at the top of the pump is both counterbored to take a sealing ring and threaded to take an adaptor.
- Item 4 PROPELLER SHAFT, 1948-49 "60" and "75"** Early 1948-49 "60" and "75" models had no provision for greasing either the journals or the sliding spline. On later models, and all Service replacements, the propeller shafts were modified to include grease nipples. The journals and sliding spline on all modified propeller shafts should be lubricated every 3,000 miles, using a good quality oil to specification S.A.E. 140. This should be brought to the notice of all owners of 1948-49 "60" and "75" models.
- Item 5 SHOCK ABSORBERS, LAND-ROVER AND CAR** Monro Matic telescopic shock absorbers have previously been supplied in gun-metal grey finish. This has been discontinued and future supplies will be finished in black. They can be easily identified as the Rover part number is given on the upper portion of the outer sleeve.
- Item 6 WELDING AND FILLING BODY PANELS, LAND-ROVER AND 1950-54 CAR** As you are aware, the Land-Rover bodywork and the door, boot and bonnet panels on the 1950-54 Rover cars are made from BIRMABRIGHT. BIRMABRIGHT is an alloy of aluminium, and, consequently repair by welding requires a special technique and material. Actually BIRMABRIGHT can be welded with ease providing the right material, tools and method are employed. For some time past we have studied this job with the object of simplifying the methods and also ensuring that the correct material and tools are readily available. As a result of this research we are now in a position to offer a kit of tools and material in kit form complete in every detail including simple instructions at a reasonable cost. We are also in a position to demonstrate the welding technique in our Service School at Solihull. Full details concerning prices will be sent to you shortly, but in the meantime any enquiries will be promptly dealt with.
- ROVER "60", "75" and "90"**
- Item 7 OIL FILTER "60" and "90"** When fitting a new oil filter element on the 1954 "60" and "90" it is essential also to fit the joint washer supplied with each element. Failure to do so may result in oil leaks as the original rubber joint washer invariably swells and is then difficult to replace. This information should be brought to the notice of all Workshop personnel immediately.
- Item 8 FAN BLADE "75"** To stiffen up the fan blade on "75" models, a reinforcing plate part number 244318 has been fitted. It was introduced from cars numbered 44301750, 44330402, 44360360 and 44760009 onwards. This reinforcing plate can be fitted to any earlier 1954 "75" model.
- Item 9 THERMOSTAT SWITCH "90"** To protect the terminal of the thermostat switch from the air cleaner on the "90", a rubber boot, part number 246241, has been introduced from cars numbered 45300247, 45330162 and 45360377 onwards. This can be fitted to any earlier 1954 "90" model if required.
- Item 10 GEARBOX COVER "60", "75" and "90"** To provide access to the reverse stop an additional rubber grommet has been fitted to the gearbox cover. The rubber grommet, part number 305016, has been fitted from cars numbered, "60" 43300315, 43330003 and 43360003 onwards; "75" 44301743, 44330402, 44360360 and 44760009 onwards; "90" 45300204, 45330114 and 45360263 onwards.